



ROYAL  
**GRAVITAZ**



Premium Residential Apartments





*Welcome*

to the countdown of

**LIMITLESS HAPPINESS**





One Project. Limitless Happiness.

Images for illustration purposes only

# 12 FLOOR TOWER



Earthquake Resistant Structure



Contemporary Facade



Marvellous Architecture

## Rise high with soaring heights...

Relish the enticing luxurious lifestyle and facilities with limitless happiness pooled up for you in a 12 floor tower at Royal Gravitaz by Ganga Kotecha Group. Each floor in itself is a new definition in quality standards and innovation.

Images for illustration purposes only

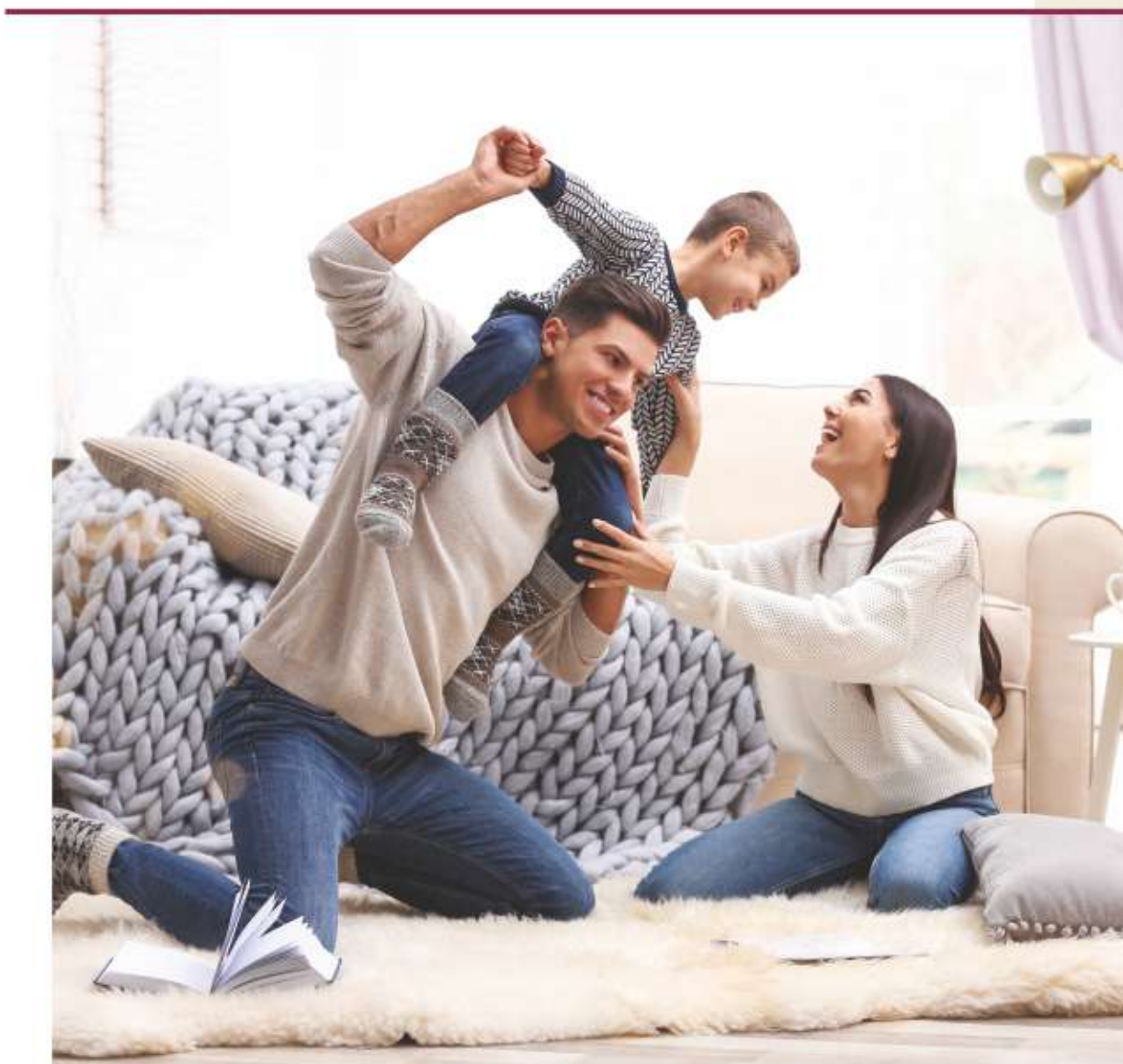





Images for illustration purposes only

# 11 TERRACE GARDENS

Lush green with beauty serene...

Royal Gravitaz brings to you the choicest of garden terraces with each floor having different concept based terrace garden to be a witness to all your limitless happiness.



LOUNGE GARDEN - Fourth Floor



KIDS GARDEN - Fifth Floor



INTERACTIVE GARDEN - Sixth Floor



AROMATIC GARDEN - Seventh Floor



MEDITATION GARDEN - Eighth Floor



SCULPTURE GARDEN - Third Floor

Images for illustration purposes only



Enjoy the goodness of nature that adds harmony to your home keeping your living space fresh, blooming and cool, which in turn will refresh your heart and soul.



Concept based gardens



VERTICAL GARDEN - Tenth Floor



Double height gardens



SWING GARDEN - Twelfth Floor



Variegated plantation



ALFRESCO GARDEN - Ninth Floor



BAMBOO GARDEN - Eleventh Floor

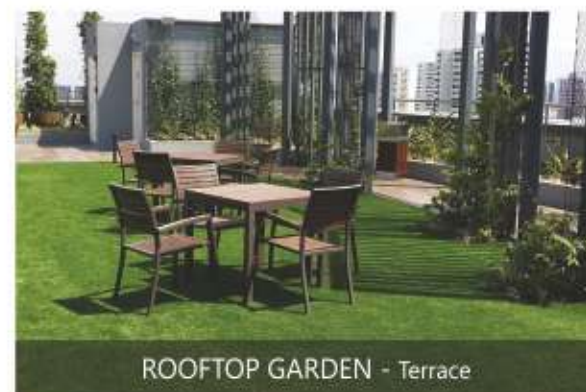

ROOFTOP GARDEN - Terrace

Soak in the joy of a green life as every floor has a beautiful garden letting you live each day close to the nature which is at its best. Let your days rise with sunshine.

Images for illustration purposes only

# 10 UNIQUE LAYOUTS



Abundant light  
& ventilation



Well planned  
layouts

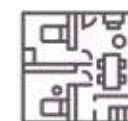

10 Flats on  
each floor

## Exclusivity is a virtue, not a toll...

Your home is a reflection of you. Exclusively designed layouts of apartments in Royal Gravitaz will reflect your achievements in form of your elite class lifestyle and living standards.

Images for illustration purposes only





ROOFTOP  
at  
ROYAL GRAVITAZ



Images for illustration purposes only

9  
ROOFTOP  
AMENITIES

Heaven under your feet and over your head...

Enjoy the breathtaking beauty of nature with comfort and ease on the rooftop of Royal Gravitz. We bring the choicest amenities to make your mornings energetic and evenings peaceful.



Open Viewing Deck



Walking Track



Gazebo Sitting

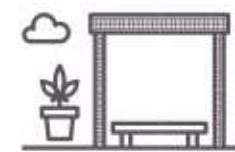

Trellised Seating



Interactive Seating Area



Yoga Deck



Aromatic Plantation



Party Deck



Sky Lounge

Images for illustration purposes only







Images for illustration purposes only

# 8 CONVENIENCE AMENITIES

## Contentment on each step & in each view...

Royal Gravitaz is a future ready masterpiece where all the facilities required to make your life easy and convenient are available and your well being is well assured.



4 High Speed Elevators



Club Oasis



Emergency Exit via extra staircase



Intercom in all Flats



Multi-Dwelling Unit for DTH



Reticulated LPG System



Power Backup in Common Areas

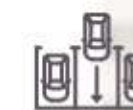

Variegated Parking



Images for illustration purposes only



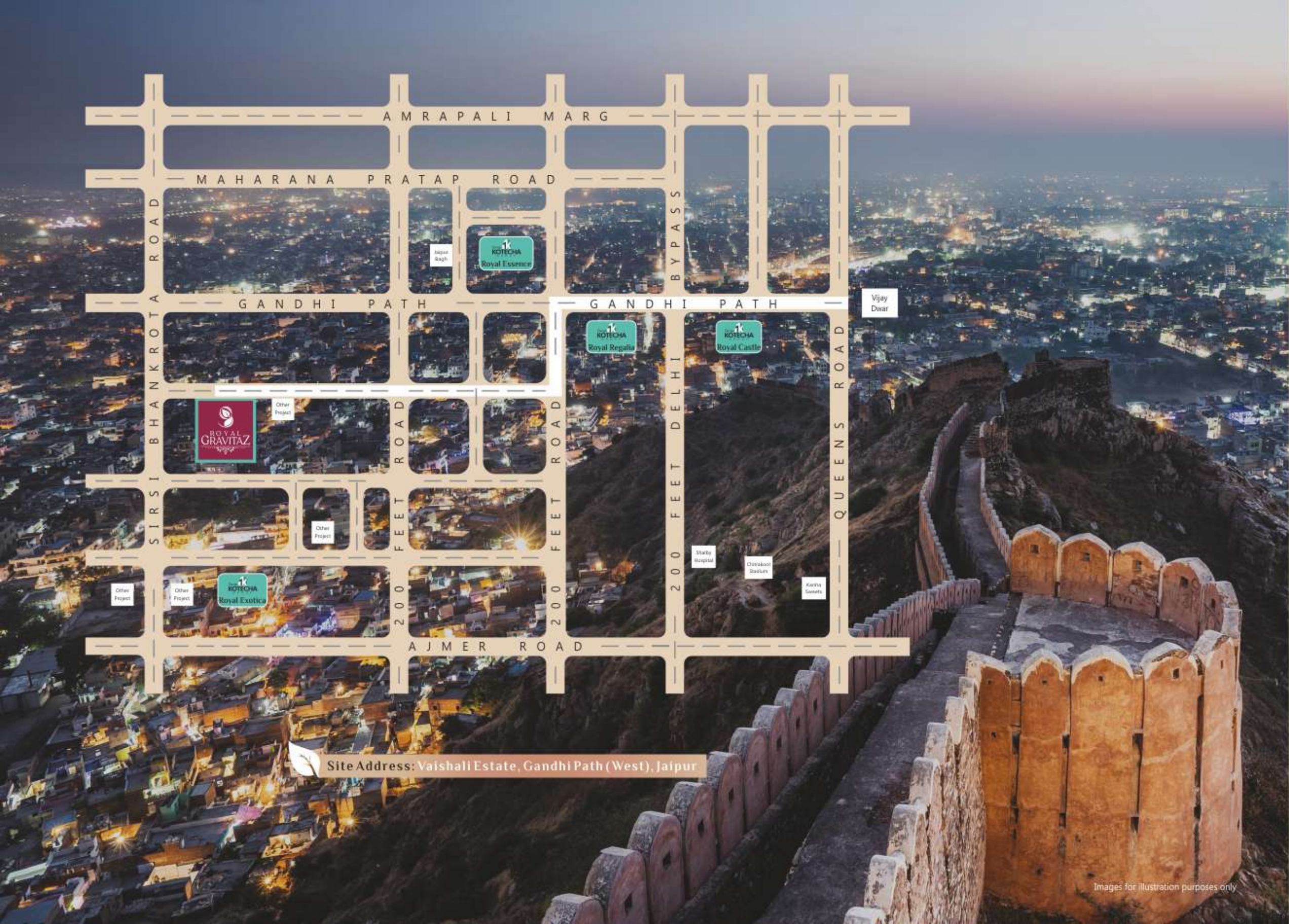

Site Address: Vaishali Estate, Gandhi Path (West), Jaipur

Images for illustration purposes only

# 7 LOCATION ADVANTAGES

## Every speciality in vicinity...

For your comfortable living, Royal Gravitaz is well linked with all the prominent places of personal and professional importance.



Scan QR Code for Location

Images for illustration purposes only







# 6 LIFESTYLE AMENITIES



EQUIPPED GYMNASIUM

**Well assured fitness & wellness...**  
Burn up your body & crunch up your mornings & evenings to meet your fitness goals.



GUEST ROOM



MULTIPURPOSE HALL

**When your life needs a break...**  
Take a pause from your busy schedule and have fun with your pals.



INDOOR GAMES ROOM

**Guests should reside at best...**  
Let your guests take comfort & satisfaction in their hearts by arranging their stays.

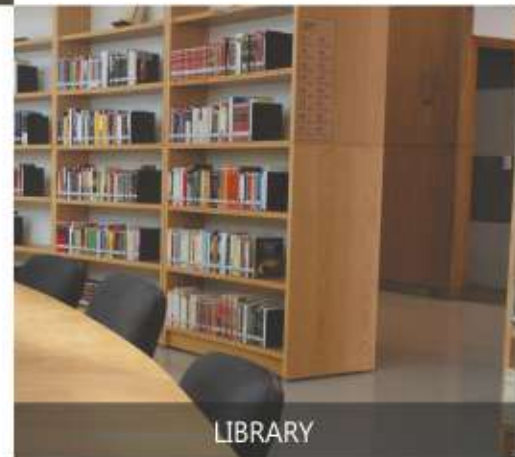

LIBRARY

**Class amidst the mass...**  
Get together for all the occasions of your life at the luxurious space we have created.

**Learning with leisure...**  
Enhance your knowledge and that of your tiny tots and make learning ever more fun.



CRECHE





Images for illustration purposes only

# 5 RELAXING AMENITIES

Unwind life in timeless occasions...

Let your life achieve active fullness by the way of relaxation, leisure, recreation and fitness. Club Oasis brings to you new avenues of a truly flowing life. Dive into your desires and feel the joy entering every inch of your body, mind and soul.



STEAM



JACUZZI



SAUNA



SWIMMING POOL



MASSAGE ROOM

Images for illustration purposes only





Images for illustration purposes only

# 4 TIER SECURITY

## Prime priority is security...

Royal Gravitaz has a flawless, reliable 4 tier security at 4 levels of this project specially designed for your safety and security.

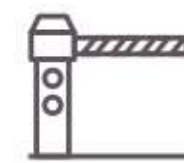

Entrance Level



Project Level



Tower Level

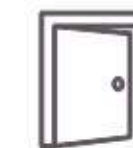

Unit Level



GUARD INTERCEPTION

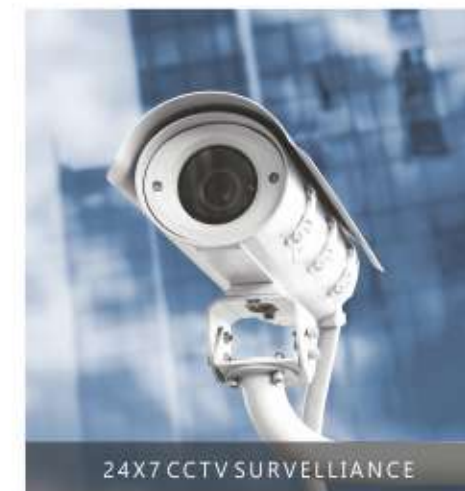

24X7 CCTV SURVEILLIANCE



ACCESS CONTROL SYSTEM



VIDEO DOOR PHONE

Let your kids, elders and family members breathe in the secure air and feel ever more protected and safe.

Images for illustration purposes only





Images for illustration purposes only



### Abode glorified, life dignified...

Infuse richness, elegance and class in all your personal moments in your personalised kingdom at Royal Gravitaz.

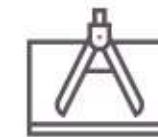

Practical  
Balance

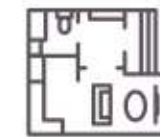

Judicious  
Space Usage



Spacious Kitchen,  
Drawing & Bedrooms



DRAWING ROOM



KITCHEN

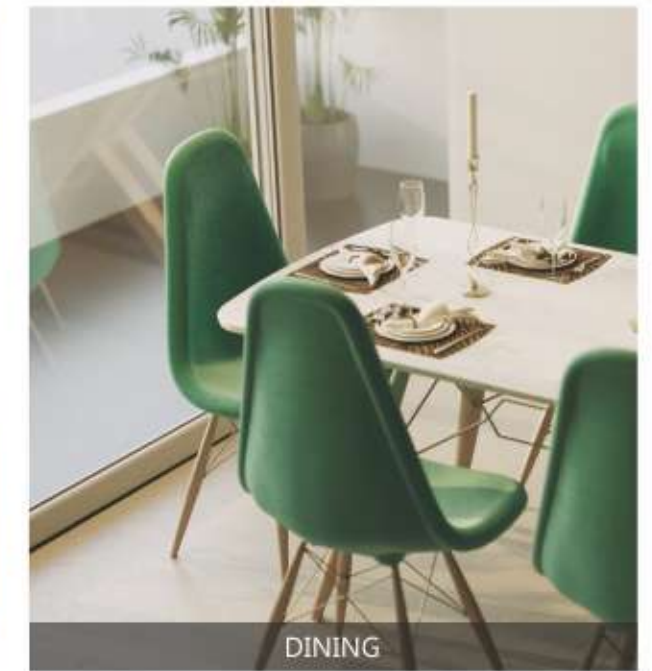

DINING

Images for illustration purposes only





Images for illustration purposes only

## 2 OUTDOOR GARDENS

### Peace in the lap of green environs...

Experience nature with added charm in the two outdoor gardens of Royal Gravitaz. Let your kids live their childhood in the arms of natural landscaped goodness.



Amphitheatre  
Styled Seating



Green  
Environs



Kids Play  
Area



Interactive  
Seating Area



FRONT GARDEN

Images for illustration purposes only



BACK GARDEN





- 12 FLOOR TOWER
- 11 TERRACE GARDENS
- 10 UNIQUE LAYOUTS
- 9 ROOFTOP AMENITIES
- 8 CONVENIENCE AMENITIES
- 7 LOCATION ADVANTAGES
- 6 LIFESTYLE AMENITIES
- 5 RELAXING AMENITIES
- 4 TIER SECURITY
- 3 DESIGN PHILOSOPHY
- 2 OUTDOOR GARDENS

Images for illustration purposes only





**One PROJECT. Limitless HAPPINESS.**



**ROYAL GRAVITAZ**

Premium Residential Apartments

Images for illustration purposes only



# TYPICAL FLOOR PLAN



3BHK - 401

2BHK - 410

2BHK - 409

2BHK - 408

2BHK - 407

3BHK - 406

Flat	Type	Super Built Up Area	Built Up Area	Carpet Area	Balcony Area
401	3 BHK	1459	1095	949	92
402	3 BHK	1466	1100	942	97
403	3 BHK	1411	1059	890	99
409	2 BHK	1078	809	695	59
410	2 BHK	1114	836	701	84

• All areas are in square feet.



Images for illustration purposes only

Flat	Type	Super Built Up Area	Built Up Area	Carpet Area	Balcony Area
404	2 BHK	984	738	635	49
405	3 BHK	1377	1033	898	79
406	3 BHK	1417	1063	926	84
407	2 BHK	1073	805	647	112
408	2 BHK	1094	821	657	110

• All areas are in square feet.



Images for illustration purposes only





**3 BHK** | **FLAT - 401**

SBUA : 1459 sq. ft.  
 BUA : 1095 sq. ft.  
 Carpet Area : 949 sq. ft.  
 Balcony Area : 92 sq. ft.

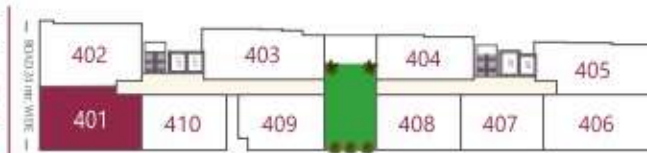

**3 BHK** | **FLAT - 402**

SBUA : 1466 sq. ft.  
 BUA : 1100 sq. ft.  
 Carpet Area : 942 sq. ft.  
 Balcony Area : 97 sq. ft.

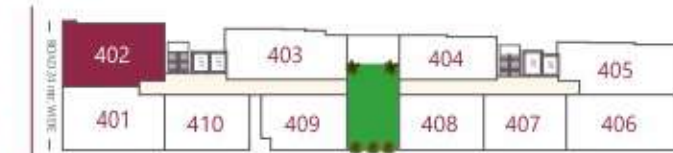

**3 BHK** | **FLAT - 403**

SBUA : 1411 sq. ft.  
 BUA : 1059 sq. ft.  
 Carpet Area : 890 sq. ft.  
 Balcony Area : 99 sq. ft.

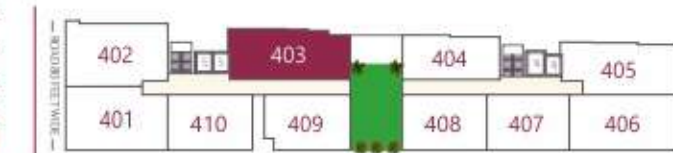

**2 BHK** | **FLAT - 404**

SBUA : 984 sq. ft.  
 BUA : 738 sq. ft.  
 Carpet Area : 635 sq. ft.  
 Balcony Area : 49 sq. ft.

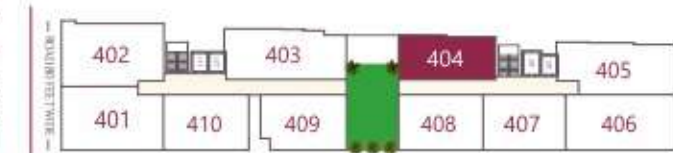





**3 BHK** | **FLAT - 405**

SBUA : 1377 sq. ft.  
 BUA : 1033 sq. ft.  
 Carpet Area : 898 sq. ft.  
 Balcony Area : 79 sq. ft.

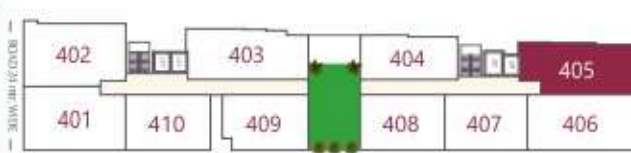

**3 BHK** | **FLAT - 406**

SBUA : 1417 sq. ft.  
 BUA : 1063 sq. ft.  
 Carpet Area : 926 sq. ft.  
 Balcony Area : 84 sq. ft.

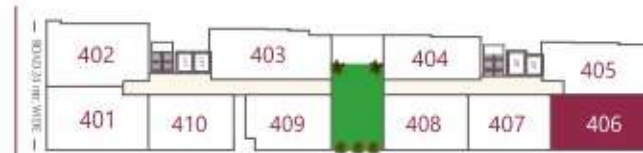

Images for illustration purposes only



**2 BHK** | **FLAT - 407**

SBUA : 1073 sq. ft.  
 BUA : 805 sq. ft.  
 Carpet Area : 647 sq. ft.  
 Balcony Area : 112 sq. ft.

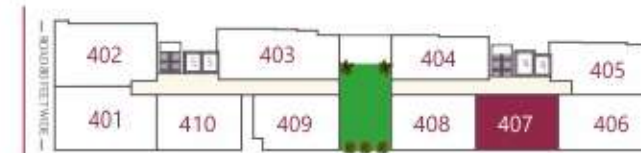

Images for illustration purposes only



**2 BHK** | **FLAT - 408**

SBUA : 1094 sq. ft.  
 BUA : 821 sq. ft.  
 Carpet Area : 657 sq. ft.  
 Balcony Area : 110 sq. ft.

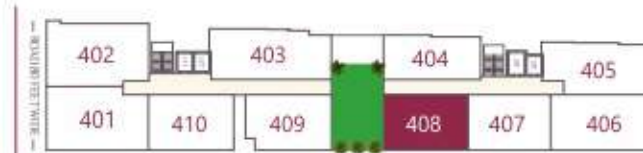

Images for illustration purposes only





**2 BHK | FLAT - 409**

SBUA : 1078 sq. ft.  
 BUA : 809 sq. ft.  
 Carpet Area : 695 sq. ft.  
 Balcony Area : 59 sq. ft.

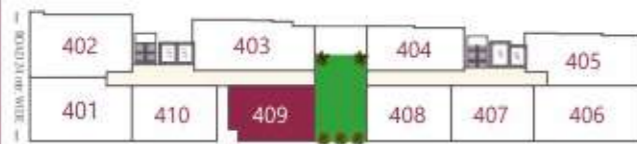

**2 BHK | FLAT - 410**

SBUA : 1114 sq. ft.  
 BUA : 836 sq. ft.  
 Carpet Area : 701 sq. ft.  
 Balcony Area : 84 sq. ft.

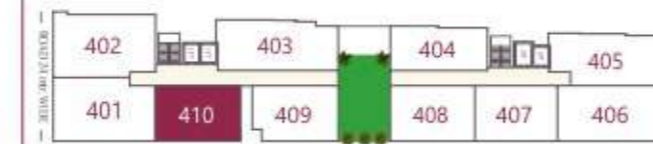

Images for illustration purposes only

## GROUND FLOOR PLAN



- A** Entry - Exit
- B** Parking
- C** Ramp to Basement
- D** Lobby Entrance
- E** Welcome Lobby
- F** Gymnasium
- G** Creche
- H** Welcome Lobby
- I** Games Room
- J** Society Office
- K** Multipurpose Hall
- L** Back Garden
- M** Outdoor Kids Play Area
- N** Front Garden
- O** Aromatic Plantation
- P** Amphitheatre Styled Seating



The plan shown above is indicative in nature. The nature, scope, extent, location and provision of all facilities and salient features including the outer development of the project is subject to change at the discretion of the developer and/or the architect.

Images for illustration purposes only



- Earthquake resistant RCC framed structure.
- Fire fighting system.
- Emergency exit provision through an extra staircase.
- Energy efficient & eco-friendly design.
- Contemporary facade and elevation elements.



## STRUCTURE

- Vitrified tiles flooring.
- POP finish on all walls and ceilings.
- Premium quality distemper on all walls and ceilings.
- UPVC/Aluminium windows with two track system.
- Premium quality designer laminated flush doors.
- Designer fittings on doors and windows.



## APARTMENTS

- AC copper wiring in drawing, dining and all bedrooms.
- Premium quality wires and cables.
- Premium quality modular switches & accessories.
- Telephone wiring in each room.
- DTH wiring in drawing room and all bedrooms.
- Intercom/EPABX facility.



## ELECTRICAL

- Round the clock 4 tier security.
- Guard Interception and boombarrier at main gate.
- 24 X 7 CCTV Surveillance.
- Access Control System at main entrance lobby.
- Video door phone in each flat.
- Safe & secure neighbourhood.
- Emergency alarm button in each flat.



## SECURITY



## KITCHENS & WATER SUPPLY

- Under counter semi modular cabinets.
- Granite working counters.
- Stainless steel sink.
- 2' tiles dado above counter.
- Provision for geyser and RO.
- 24 X 7 Water Supply in all flats through overhead tank.
- Underground water tank for additional storage.



## WASHROOMS

- Designer ceramic wall tiles up to 7' height.
- Ceramic tile flooring.
- Premium quality sanitary ware.
- Premium quality CP fittings.
- Extended wall hung/floor mounted water closets.
- Counter wash basins with mirrors.
- Grid false ceiling.



## COMMON AMENITIES

- Clubhouse consisting of swimming pool, gymnasium, creche, spa, games room and guest room.
- Spa consisting of steam, sauna, jacuzzi and massage room.
- Indoor Games Room consisting of pool, table tennis, carrom and chess.
- 4 Automatic Elevators.
- Reticulated LPG System.



## COMMON AMENITIES

- Multi - Dwelling Unit (MDU) system for DTH connectivity.
- Power backup in common areas.
- Rainwater harvesting system to recharge ground level.
- Main entrance gate with separate entry & exit driveways.
- Granite flooring in corridors and staircases.
- Designer entrance lobbies.
- Double height terrace sit out areas.





Imbibing royalty with unbound customer satisfaction, Ganga Kotecha Group is creating ecosystems of pre – eminent standards and prime amenities giving rich experience of royal living since the past 15 years.

Our top most priority is your comfortable living as we have a strong belief that the thing that will last for a lifetime is experience and memories. Working up on this philosophy we boast to be the creators of some magnificent residential properties with top class amenities.

We are well focused on creating homes, memories and luxurious lifestyle for our esteemed and valuable clients rather than mere houses.



Scan QR Code for Website



It takes hands to build a house, but only hearts can build a home.





One **PROJECT**. Limitless **HAPPINESS**.



**Ridhi Sidhi Prime Realty LLP**

Corporate Office - 81, Gyan Vihar Colony, Nirman Nagar, Jaipur

Phone - 0141 - 4015550, 4016660, 4017770

[www.kotechagroup.org](http://www.kotechagroup.org)

For more details, Call -

**7073099222, 9001919111**

All pictures and/or rendered images including the colour of the building depicted in this brochure are of an indicative nature only and have been used for illustration purposes. Photographs showing the surrounding views and location may have been digitally enhanced or altered and do not represent the actual views. All finishes/details/specifications are subject to change at the discretion of the developers and/or the architects. All areas depicted herein are approximate in nature. This brochure is purely conceptual and does not constitute an offer for sale or any form of agreement/contract. All purchases shall be solely governed by the terms of the agreement for sale.